

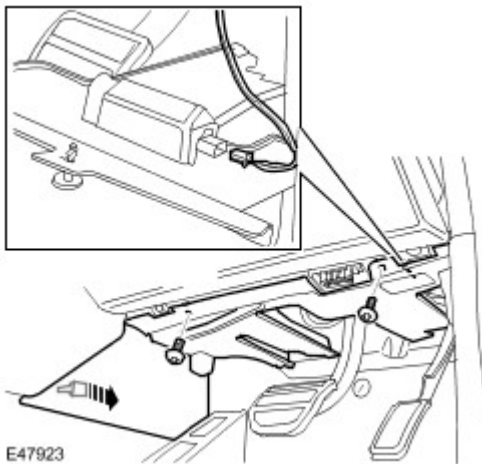

## Clutch Pedal (33.30.02)

### Removal

1. Remove the brake booster. For additional information, refer to [Brake Booster \(70.50.01\)](#) (Section 206-07)
2. Remove the headlamp switch. For additional information, refer to [Headlamp Switch \(86.65.09\)](#) (Section 417-01)
3. Remove the driver side closing trim panel.
  - ▶ Release the clip.
  - ▶ Remove the 2 screws.
  - ▶ Disconnect the electrical connector.



4. Remove the instrument panel access panel.
  - ▶ Release the 2 clips.

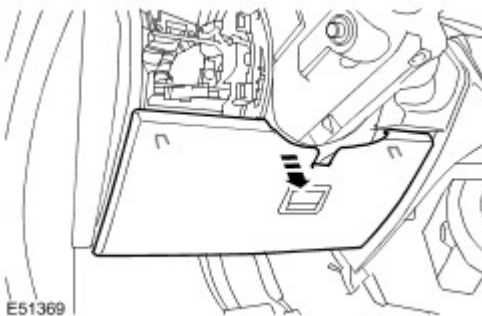

5. Remove the brake pedal bracket.
  - ▶ Release the wiring harness clip.
  - ▶ Remove the 4 Torx bolts.

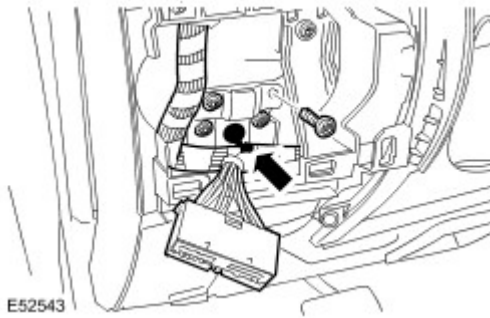

6. Release the stoplamp wiring harness.
  - ▶ Disconnect the electrical connector.
  - ▶ Release the 2 clips.

7. Remove the stoplamp switch.

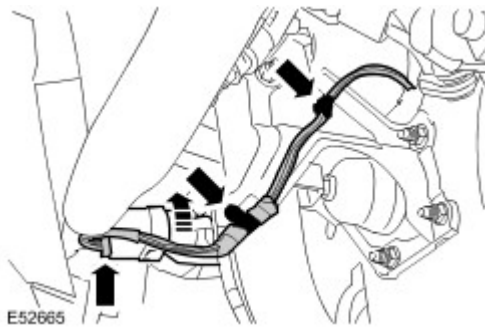

8. Remove clutch pedal spring assister.
9. Release the clutch master cylinder.
  - ▶ Release the clutch master cylinder clevis pin.
  - ▶ Remove the 2 nuts.

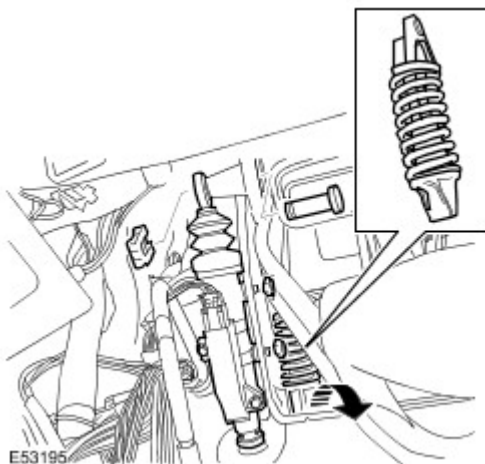

10. Remove the pedal assembly.
  - ▶ Remove the 2 nuts.

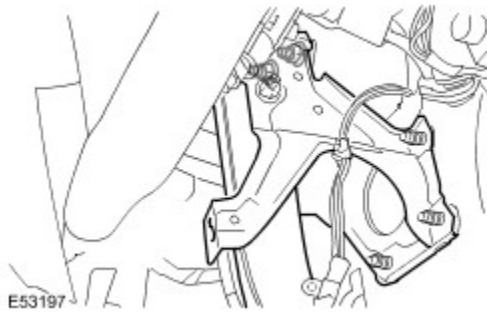

11. **NOTE :**  
Do not disassemble further if the component is removed for access only.  
Remove the brake pedal pad.
12. Remove the clutch pedal pad.
13. Remove the pedals.
  - ▶ Carefully release the spring tension.
  - ▶ Remove the bolt and discard the nut.

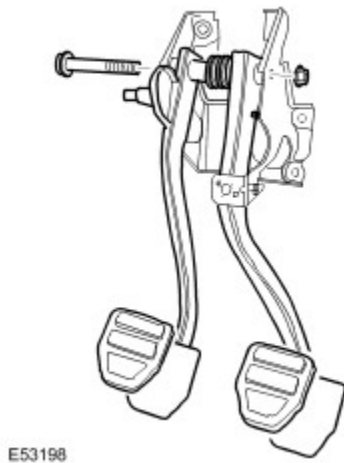

14. Remove the 3 pedal bushings.

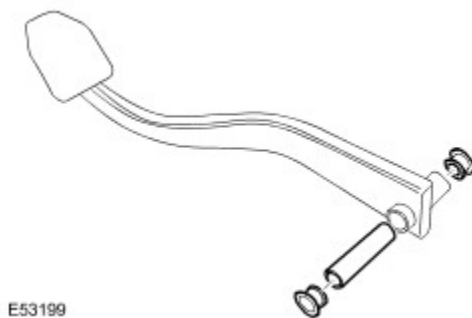

## Installation

1. Install the bushing.

- ▶ Clean the component mating faces.
  - ▶ Lubricate the components.
- 2 . Install the pedals.
    - ▶ Install the return spring.
    - ▶ Tighten the nut and bolt to 45 Nm (33 lb.ft).
  - 3 . Install the clutch pedal pad.
  - 4 . Install the brake pedal pad.
  - 5 . Install the stoplamp switch.
  - 6 . Install the pedal assembly.
    - ▶ Tighten the nuts to 25 Nm (18 lb.ft).
  - 7 . Install the clutch master cylinder.
    - ▶ Tighten the nuts to 10 Nm (7 lb.ft).
    - ▶ Install the clevis pin.
  - 8 . Install the clutch pedal spring assister.
  - 9 . Secure the wiring harness.
    - ▶ Secure the clips.
    - ▶ Connect the electrical connector.
  - 10 . Install the brake pedal bracket.
    - ▶ Tighten the Torx bolt to 10 Nm (7 lb.ft).
    - ▶ Secure the wiring harness.
  - 11 . Install the instrument panel access panel.
    - ▶ Secure with the clips.
  - 12 . Install the closing trim panel.
    - ▶ Connect the electrical connector.
    - ▶ Secure the clip.
    - ▶ Tighten the screws.
  - 13 . Install the headlamp switch. For additional information, refer to [Headlamp Switch \(86.65.09\)](#) (Section 417-01)
  - 14 . Install the brake booster. For additional information, refer to [Brake Booster \(70.50.01\)](#) (Section 206-07)